

# rafavi Rafavi Touchscreen Bluetooth Headset Manual

## Product

产品型号:	R10	年款:	2024
品牌:	rafavi	车型:	-

## 功能特点

Main Functions:

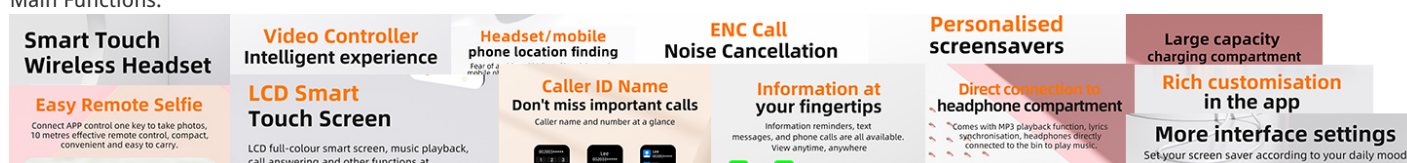

APP Expansion/Local Dialling/Local Music Playback/External Memory Card/Multi-language / Photo Control /Short Video Control / ENC Call Noise Reduction / SMS Alert /Find Phone Find Headset/Wallpaper Switching/Stopwatch/Alarm Clock

Connection Tutorial :

1.Download "Caldecott" APP to your mobile phone and install it

you can search for "Caldecott" in the APP mall (Android App Store).

Search "Caldecott" in the APP Store (Android App Store). You can also scan the following QR code to jump to the connection to download (browser, WeChat, etc. can scan the code).



2.Connecting the charging compartment.

(1) The charging warehouse will automatically turn on the Bluetooth by default, and make sure the Bluetooth of your mobile phone is on. Open the mobile phone APP "Caldecott, in the "device" interface "add device".

(2) Search the device model, click to connect. After connecting successfully, the device model (connected) will be displayed under "Devices" in APR

3. Bluetooth connection between headset and mobile phone.

1) Open the charging compartment, the Bluetooth of the headset will be turned on automatically.

2) Next, open your mobile phone, settings options, open the Bluetooth, mobile phone Bluetooth will automatically search for nearby Bluetooth devices, and then find the name of the Bluetooth headset

in the available devices below and click on the pairing, complete the connection between the headset and mobile

phone.

#### 4. Connection and pairing notes.

- 1) Make sure the Bluetooth of your mobile phone is on.
- 2) Make sure the device is fully charged, please switch it on or charge it before use.
- 3) Make sure the device is within 50cm from the mobile phone when pairing and connecting.
- 4) If you can't find the device in the APP, please check whether "Caldecott" is allowed to use Bluetooth in the mobile phone's permission settings.
- 5) Make sure the headset is removed from the headset compartment when pairing.
- 6) If the headset or mobile phone has been paired with other Bluetooth devices during the period, you need to reconnect.



#### Headset operating instructions:

.Power on: Press and hold for 3 seconds

.Shut down: Press and hold for 5 second

.Pause/Play: Double-click on a function key

.Previous song: Three-strike function key (L)

.Next song: Three-strike function key (R)

.Answer/hang up: Click on a function key

.Reject incoming calls: Long press the function button for 1.5 seconds.

.Volume increase: Press and hold the L button for 1.5 seconds

.volume reduction: Press and hold the R button for 1.5 seconds

.voice assistant: Four-tap function key (L) to activate Siri

.Game mode: Four-tap function key (R) to switch game mode/music mode

.Restore Factory Settings: Five clicks on the function key (to clear the pairing record), without connecting to the mobile phone

#### Product Parameters

Wireless version	V5.4
Horn (automobile etc)	1.3mm
Screen	1.83 TFT
(level of) sensitivity	103±3dB

Bluetooth reception distance	≥ 10M(ccessibility)
Frequency Range	20HZ-20KHZ
Impedance	32Ω=15%
Transmission range	2400.0- 2483.5MHz
Supported Protocols	HSP/HFP/ADP/SBC/ACC/AVRCP
Transmission frequency	2.4 GHZ - 2.4835 GHZ SMBand
Headset charging time	1h (earphones),reduce 2h (battery compartment)
Playing time	5-6 h (60%loudness)
Airtime	5-6 h (60%loudness)
Endurance	In the bluetooth headset and mobile phone to open the connection state call length,about 5-6 hours (binaural calls)
Product working temperature	-10-50 C (Rated input of earphone: DC 5v-35 mAh )
Product Storage Temperature	-20-55 C (Rated input of charging chamber: DC 5v = 600mAh)

## Installation Procedure

function\_operation\_diagram\_open\_connect\_dual\_connection\_synchronisation

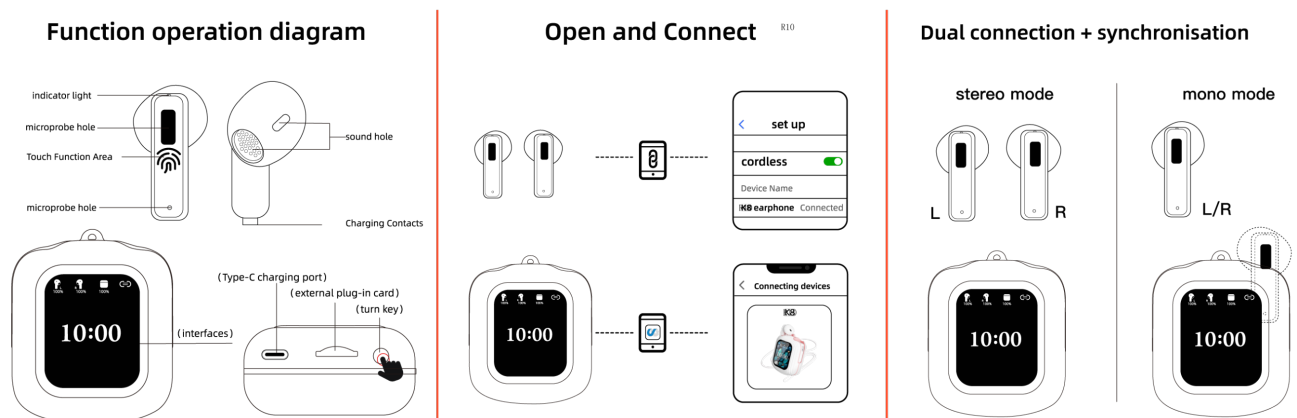

## 注意事项

### Product Safety Information:

Please read all instructions and warnings before using this product, unregulated use will cause damage to the product or personal safety.

1. The product contains a battery, do not expose the product to strong sunlight or overheating such as a furnace. Do not store the product in high temperature, strong light and strong magnetic field environment.
2. The product should not be placed in a harsh environment such as near a fire source. Prohibit knocking, throwing, trampling, squeezing or putting into the fire, if there is bulging, please do not use.
3. The ambient temperature of the product is 0~45°C.
4. Please do not violate the product instructions. Improper use, resulting in product damage or endanger the safety of personal property, the consequences of their own responsibility.
5. No reason is strictly prohibited from disassembling the product, which may result in fire or even complete damage to the product.
6. Please do not use the product beyond the output current load (electrical appliances), beyond the load will automatically stop working.
7. Please use a clean cotton cloth to clean the charging contacts of the headset regularly, in order to avoid the headset can not be charged or switched on due to the long term not clean.  
to prevent the headset from not charging or switching on due to long-term uncleanliness.
8. Please do not put the product in water (or washing machine), if the product into the water, please wait for it to dry naturally before use

### FCC Caution:

This device complies with part 15 of the FCC Rules. Operation is subject to the following two conditions:

- (1) This device may not cause harmful interference, and
- (2) This device must accept any interference received, including interference that may cause undesired operation.

Any Changes or modifications not expressly approved by the party responsible for compliance could void the user's authority to operate the equipment.

Note: This equipment has been tested and found to comply with the limits for a Class B digital device, pursuant to part 15 of the FCC Rules.

These limits are designed to provide reasonable protection against harmful interference in a residential installation. This equipment generates uses and can radiate radio frequency energy and, if not installed and used in accordance with the instructions, may cause harmful interference to radio communications. However, there is no guarantee that interference will not occur in a particular installation.

If this equipment does cause harmful interference to radio or television reception, which can be determined by turning the equipment off and on, the user is encouraged to try to correct the interference by one or more of the following measures:

- Reorient or relocate the receiving antenna.
- Increase the separation between the equipment and receiver.
- Connect the equipment into an outlet on a circuit different from that to which the receiver is connected.
- Consult the dealer or an experienced radio/TV technician for help.

The device has been evaluated to meet general RF exposure requirement. The device can be used in portable exposure condition without restriction.

---

## Common Problem and Solutions

---

Next and Previous button on compartment didn't work when listening Music

---

It need to open APP when listening music.

---

Camera on compartment didn't work

---

It need to open APP when using Camera function to take photos.Alway it is used for Remote Selfie.

---